

Surname						Other Names					
Centre Number						Candidate Number					
Candidate Signature											

Leave blank

General Certificate of Education
 January 2005
 Advanced Subsidiary Examination



PHYSICS (SPECIFICATION A)
Unit 2 Mechanics and Molecular Kinetic Theory

PA02

Wednesday 12 January 2005 Morning Session

In addition to this paper you will require:

- a calculator;
- a pencil and a ruler.

Time allowed: 1 hour

Instructions

- Use blue or black ink or ball-point pen.
- Fill in the boxes at the top of this page.
- Answer **all** questions in the spaces provided. All working must be shown.
- Do all rough work in this book. Cross through any work you do not want marked.

Information

- The maximum mark for this paper is 50.
- Mark allocations are shown in brackets.
- The paper carries 30% of the total marks for Physics Advanced Subsidiary and carries 15% of the total marks for Physics Advanced.
- A *Data Sheet* is provided on pages 3 and 4. You may wish to detach this perforated sheet at the start of the examination.
- You are expected to use a calculator where appropriate.
- In questions requiring description and explanation you will be assessed on your ability to use an appropriate form and style of writing, to organise relevant information clearly and coherently, and to use specialist vocabulary where appropriate. The degree of legibility of your handwriting and the level of accuracy of your spelling, punctuation and grammar will also be taken into account.

For Examiner's Use			
Number	Mark	Number	Mark
1			
2			
3			
4			
5			
6			
Total (Column 1)	→		
Total (Column 2)	→		
TOTAL			
Examiner's Initials			

Data Sheet

- A perforated *Data Sheet* is provided as pages 3 and 4 of this question paper.
- This sheet may be useful for answering some of the questions in the examination.
- You may wish to detach this sheet before you begin work.

Fundamental constants and values

Quantity	Symbol	Value	Units
speed of light in vacuo	c	3.00×10^8	m s^{-1}
permeability of free space	μ_0	$4\pi \times 10^{-7}$	H m^{-1}
permittivity of free space	ϵ_0	8.85×10^{-12}	F m^{-1}
charge of electron	e	1.60×10^{-19}	C
the Planck constant	h	6.63×10^{-34}	J s
gravitational constant	G	6.67×10^{-11}	$\text{N m}^2 \text{kg}^{-2}$
the Avogadro constant	N_A	6.02×10^{23}	mol^{-1}
molar gas constant	R	8.31	$\text{J K}^{-1} \text{mol}^{-1}$
the Boltzmann constant	k	1.38×10^{-23}	J K^{-1}
the Stefan constant	σ	5.67×10^{-8}	$\text{W m}^{-2} \text{K}^{-4}$
the Wien constant	α	2.90×10^{-3}	m K
electron rest mass	m_e	9.11×10^{-31}	kg
(equivalent to $5.5 \times 10^{-4} \text{u}$)			
electron charge/mass ratio	e/m_e	1.76×10^{11}	C kg^{-1}
proton rest mass	m_p	1.67×10^{-27}	kg
(equivalent to 1.00728u)			
proton charge/mass ratio	e/m_p	9.58×10^7	C kg^{-1}
neutron rest mass	m_n	1.67×10^{-27}	kg
(equivalent to 1.00867u)			
gravitational field strength	g	9.81	N kg^{-1}
acceleration due to gravity	g	9.81	m s^{-2}
atomic mass unit	u	1.661×10^{-27}	kg
(1u is equivalent to 931.3 MeV)			

Fundamental particles

Class	Name	Symbol	Rest energy /MeV
photon	photon	γ	0
lepton	neutrino	ν_e	0
		ν_μ	0
	electron	e^\pm	0.510999
	muon	μ^\pm	105.659
mesons	pion	π^\pm	139.576
		π^0	134.972
	kaon	K^\pm	493.821
		K^0	497.762
baryons	proton	p	938.257
	neutron	n	939.551

Properties of quarks

Type	Charge	Baryon number	Strangeness
u	$+\frac{2}{3}$	$+\frac{1}{3}$	0
d	$-\frac{1}{3}$	$+\frac{1}{3}$	0
s	$-\frac{1}{3}$	$+\frac{1}{3}$	-1

Geometrical equations

- arc length = $r\theta$
- circumference of circle = $2\pi r$
- area of circle = πr^2
- area of cylinder = $2\pi rh$
- volume of cylinder = $\pi r^2 h$
- area of sphere = $4\pi r^2$
- volume of sphere = $\frac{4}{3}\pi r^3$

Mechanics and Applied Physics

- $v = u + at$
- $s = \left(\frac{u+v}{2}\right)t$
- $s = ut + \frac{at^2}{2}$
- $v^2 = u^2 + 2as$
- $F = \frac{\Delta(mv)}{\Delta t}$
- $P = Fv$
- efficiency = $\frac{\text{power output}}{\text{power input}}$
- $\omega = \frac{v}{r} = 2\pi f$
- $a = \frac{v^2}{r} = r\omega^2$
- $I = \sum mr^2$
- $E_k = \frac{1}{2} I\omega^2$
- $\omega_2 = \omega_1 + at$
- $\theta = \omega_1 t + \frac{1}{2} at^2$
- $\omega_2^2 = \omega_1^2 + 2a\theta$
- $\theta = \frac{1}{2} (\omega_1 + \omega_2)t$
- $T = I\alpha$
- angular momentum = $I\omega$
- $W = T\theta$
- $P = T\omega$
- angular impulse = change of angular momentum = Tt
- $\Delta Q = \Delta U + \Delta W$
- $\Delta W = p\Delta V$
- $pV^\gamma = \text{constant}$
- work done per cycle = area of loop
- input power = calorific value \times fuel flow rate
- indicated power as (area of $p-V$ loop) \times (no. of cycles/s) \times (no. of cylinders)
- friction power = indicated power - brake power
- efficiency = $\frac{W}{Q_{in}} = \frac{Q_{in} - Q_{out}}{Q_{in}}$
- maximum possible efficiency = $\frac{T_H - T_C}{T_H}$

Fields, Waves, Quantum Phenomena

- $g = \frac{F}{m}$
- $g = -\frac{GM}{r^2}$
- $g = -\frac{\Delta V}{\Delta x}$
- $V = -\frac{GM}{r}$
- $a = -(2\pi f)^2 x$
- $v = \pm 2\pi f \sqrt{A^2 - x^2}$
- $x = A \cos 2\pi ft$
- $T = 2\pi \sqrt{\frac{m}{k}}$
- $T = 2\pi \sqrt{\frac{l}{g}}$
- $\lambda = \frac{\omega s}{D}$
- $d \sin \theta = n\lambda$
- $\theta \approx \frac{\lambda}{D}$
- ${}^1n_2 = \frac{\sin \theta_1}{\sin \theta_2} = \frac{c_1}{c_2}$
- ${}^1n_2 = \frac{n_2}{n_1}$
- $\sin \theta_c = \frac{1}{n}$
- $E = hf$
- $hf = \phi + E_k$
- $hf = E_1 - E_2$
- $\lambda = \frac{h}{p} = \frac{h}{mv}$
- $c = \frac{1}{\sqrt{\mu_0 \epsilon_0}}$

Electricity

- $\epsilon = \frac{E}{Q}$
- $\epsilon = I(R + r)$
- $\frac{1}{R_T} = \frac{1}{R_1} + \frac{1}{R_2} + \frac{1}{R_3} + \dots$
- $R_T = R_1 + R_2 + R_3 + \dots$
- $P = I^2 R$
- $E = \frac{F}{Q} = \frac{V}{d}$
- $E = \frac{1}{4\pi \epsilon_0} \frac{Q}{r^2}$
- $E = \frac{1}{2} QV$
- $F = BI l$
- $F = BQv$
- $Q = Q_0 e^{-t/RC}$

magnitude of induced e.m.f. = $N \frac{\Delta\Phi}{\Delta t}$

$I_{\text{rms}} = \frac{I_0}{\sqrt{2}}$

$V_{\text{rms}} = \frac{V_0}{\sqrt{2}}$

Mechanical and Thermal Properties

the Young modulus = $\frac{\text{tensile stress}}{\text{tensile strain}} = \frac{F}{A} \frac{l}{e}$

energy stored = $\frac{1}{2} Fe$

$\Delta Q = mc \Delta\theta$

$\Delta Q = ml$

$pV = \frac{1}{3} Nmc^2$

$\frac{1}{2} mc^2 = \frac{3}{2} kT = \frac{3RT}{2N_A}$

Nuclear Physics and Turning Points in Physics

force = $\frac{eV_p}{d}$

force = Bev

radius of curvature = $\frac{mv}{Be}$

$\frac{eV}{d} = mg$

work done = eV

$F = 6\pi\eta rv$

$I = k \frac{I_0}{x^2}$

$\frac{\Delta N}{\Delta t} = -\lambda N$

$\lambda = \frac{h}{\sqrt{2}meV}$

$N = N_0 e^{-\lambda t}$

$T_{\frac{1}{2}} = \frac{\ln 2}{\lambda}$

$R = r_0 A^{\frac{1}{3}}$

$E = mc^2 = \frac{m_0 c^2}{\left(1 - \frac{v^2}{c^2}\right)^{\frac{1}{2}}}$

$l = l_0 \left(1 - \frac{v^2}{c^2}\right)^{\frac{1}{2}}$

$t = \frac{t_0}{\left(1 - \frac{v^2}{c^2}\right)^{\frac{1}{2}}}$

Astrophysics and Medical Physics

Body	Mass/kg	Mean radius/m
Sun	2.00×10^{30}	7.00×10^8
Earth	6.00×10^{24}	6.40×10^6

1 astronomical unit = 1.50×10^{11} m

1 parsec = 206265 AU = 3.08×10^{16} m = 3.26 ly

1 light year = 9.45×10^{15} m

Hubble constant (H) = $65 \text{ kms}^{-1} \text{ Mpc}^{-1}$

$M = \frac{\text{angle subtended by image at eye}}{\text{angle subtended by object at unaided eye}}$

$M = \frac{f_o}{f_e}$

$m - M = 5 \log \frac{d}{10}$

$\lambda_{\text{max}} T = \text{constant} = 0.0029 \text{ m K}$

$v = Hd$

$P = \sigma AT^4$

$\frac{\Delta f}{f} = \frac{v}{c}$

$\frac{\Delta \lambda}{\lambda} = -\frac{v}{c}$

$R_s \approx \frac{2GM}{c^2}$

Medical Physics

power = $\frac{1}{f}$

$\frac{1}{u} + \frac{1}{v} = \frac{1}{f}$ and $m = \frac{v}{u}$

intensity level = $10 \log \frac{I}{I_0}$

$I = I_0 e^{-\mu x}$

$\mu_m = \frac{\mu}{\rho}$

Electronics

Resistors

Preferred values for resistors (E24)
Series: 1.0 1.1 1.2 1.3 1.5 1.6 1.8 2.0 2.2 2.4 2.7 3.0 3.3 3.6 3.9 4.3 4.7 5.1 5.6 6.2 6.8 7.5 8.2 9.1 ohms
and multiples that are ten times greater

$Z = \frac{V_{\text{rms}}}{I_{\text{rms}}}$

$\frac{1}{C_T} = \frac{1}{C_1} + \frac{1}{C_2} + \frac{1}{C_3} + \dots$

$C_T = C_1 + C_2 + C_3 + \dots$

$X_C = \frac{1}{2\pi f C}$

Alternating Currents

$f = \frac{1}{T}$

Operational amplifier

$G = \frac{V_{\text{out}}}{V_{\text{in}}}$ voltage gain

$G = -\frac{R_f}{R_1}$ inverting

$G = 1 + \frac{R_f}{R_1}$ non-inverting

$V_{\text{out}} = -R_f \left(\frac{V_1}{R_1} + \frac{V_2}{R_2} + \frac{V_3}{R_3} \right)$ summing

Answer **all** questions.

- 1 (a) (i) One of the assumptions of the kinetic theory of gases is that molecules make *elastic collisions*. State what is meant by an elastic collision.

.....
.....

- (ii) State **two** more assumptions that are made in the kinetic theory of gases.

.....
.....
.....
.....

(3 marks)

- (b) One mole of hydrogen at a temperature of 420 K is mixed with one mole of oxygen at 320 K. After a short period of time the mixture is in *thermal equilibrium*.

- (i) Explain what happens as the two gases approach and then reach thermal equilibrium.

.....
.....
.....
.....

- (ii) Calculate the average kinetic energy of the hydrogen molecules before they are mixed with the oxygen molecules.

.....
.....
.....

(4 marks)

7

2 (a) State the difference between vector and scalar quantities.

.....
.....
(1 mark)

(b) State **one** example of a vector quantity (other than force) and **one** example of a scalar quantity.

vector quantity

scalar quantity

(2 marks)

(c) A 12.0 N force and a 8.0 N force act on a body of mass 6.5 kg at the same time.
For this body, calculate

(i) the maximum resultant acceleration that it could experience,

.....
.....

(ii) the minimum resultant acceleration that it could experience.

.....
.....
(4 marks)

7

3 A packing case is being lifted vertically at a constant speed by a cable attached to a crane. The packing case has a mass of 640 kg.

- (a) With reference to one of Newton’s laws of motion, explain why the tension, T , in the cable must be equal to the weight of the packing case.

You may be awarded marks for the quality of written communication in your answer.

.....
.....
.....
.....
.....
.....

(3 marks)

- (b) The packing case is lifted through a vertical height of 8.0 m in 4.5 s.

Calculate

- (i) the work done on the packing case,

.....
.....

- (ii) the power output of the crane in this situation.

.....
.....
.....

(3 marks)

6

4 The graph represents the motion of two cars, A and B, as they move along a straight, horizontal road.

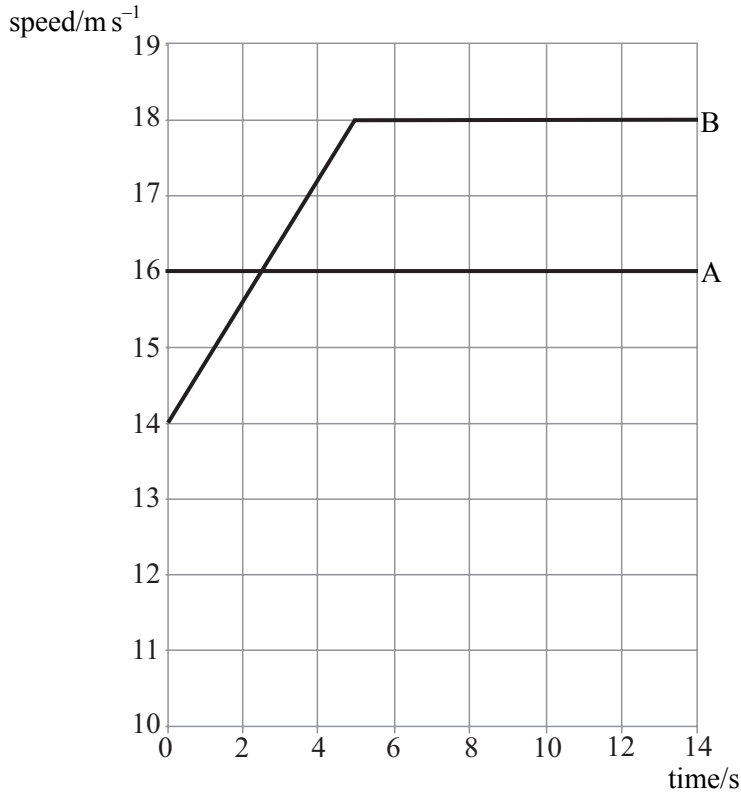

(a) Describe the motion of each car as shown on the graph.

(i) car A:

.....

(ii) car B:

.....

(3 marks)

(b) Calculate the distance travelled by each car during the first 5.0 s.

(i) car A:

.....

.....

(ii) car B:

.....

.....

(4 marks)

- (c) At time $t = 0$, the two cars are level. Explain why car A is at its maximum distance ahead of B at $t = 2.5$ s

.....

.....

.....

.....

.....

(3 marks)

10

TURN OVER FOR THE NEXT QUESTION

5 A female runner of mass 60 kg generates thermal energy at a rate of 800 W.

(a) Assuming that she loses no energy to the surroundings and that the average specific heat capacity of her body is $3900 \text{ J kg}^{-1} \text{ K}^{-1}$, calculate

(i) the thermal energy generated in one minute,

.....

(ii) the temperature rise of her body in one minute.

.....

(3 marks)

(b) In practice it is desirable for a runner to maintain a constant temperature. This may be achieved partly by the evaporation of sweat. The runner in part (a) loses energy at a rate of 500 W by this process.

Calculate the mass of sweat evaporated in one minute.

specific latent heat of vaporisation of water = $2.3 \times 10^6 \text{ J kg}^{-1}$

.....

(3 marks)

(c) Explain why, when she stops running, her temperature is likely to fall.

.....

(2 marks)

- 6 (a) Define the moment of a force about a point.

.....

.....

.....

(2 marks)

- (b) The diagram shows a trailer attached to the towbar of a stationary car. The weight of the trailer is 1800 N and is shown acting through its *centre of gravity*. F is the force exerted by the towbar on the trailer. F_R is the **total** normal reaction force experienced by the trailer. When stationary all forces acting on the trailer are vertical.

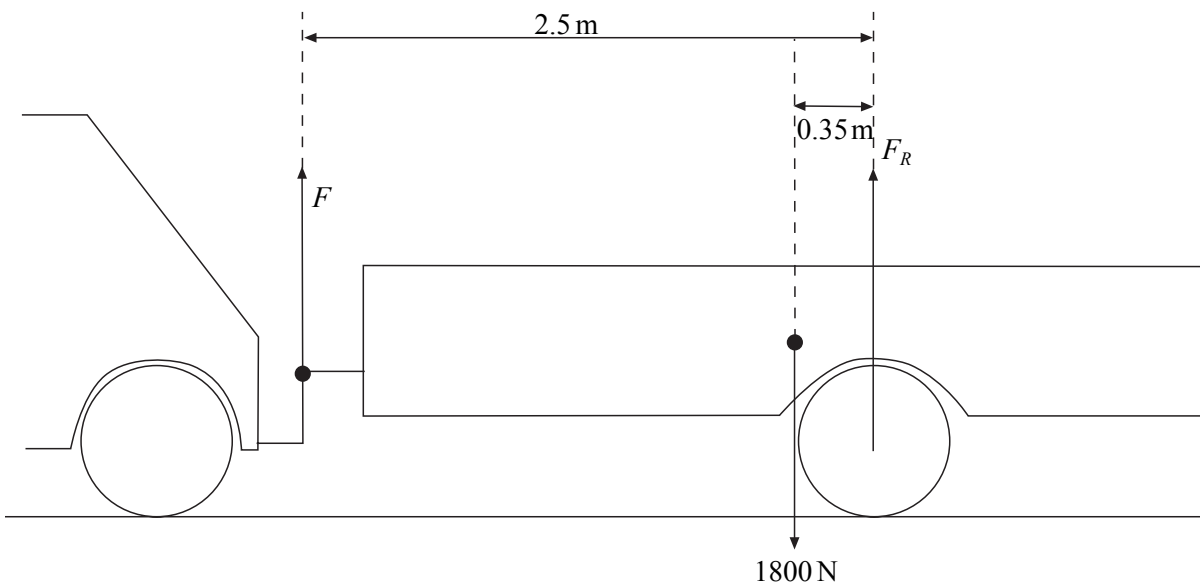

- (i) Explain what is meant by centre of gravity.

.....

.....

- (ii) Calculate the force, F , exerted by the towbar on the trailer.

.....

.....

.....

(3 marks)

- (iii) Calculate F_R .

.....

.....

.....

(2 marks)

- (c) The car starts to move forwards. State and explain what happens to the magnitude and direction of force, F .

You may be awarded marks for the quality of written communication in your answer.

.....

.....

.....

.....

.....

.....

(3 marks)

$\frac{\quad}{10}$

QUALITY OF WRITTEN COMMUNICATION (2 marks)

$\frac{\quad}{2}$

END OF QUESTIONS